

INTERCHANGE UNIT
(Machine Code: G305)

1. REPLACEMENT AND ADJUSTMENT

⚠ CAUTION
 Turn off the main power switch and unplug the machine before beginning any of the procedures in this section.

NOTE: This manual uses the following symbols.

☛ : See or Refer to 🔩 : Screws 📡 : Connector

1.1 EXTERIOR COVER AND PAPER EXIT SENSOR

- [A]: Exterior cover
- [B]: Inner cover (🔩 x 3)
- [C]: Paper exit sensor (📡 x 1)

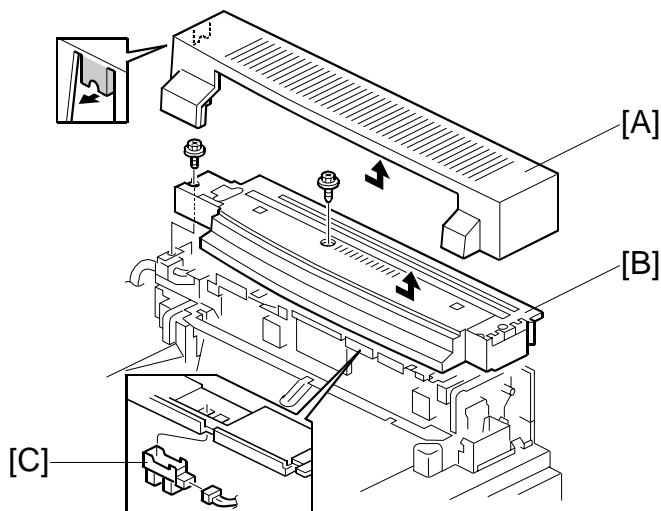

G305R101.WMF

1.2 CONTROL BOARD

- [A]: Control board (1 hook, 📡 x 9)

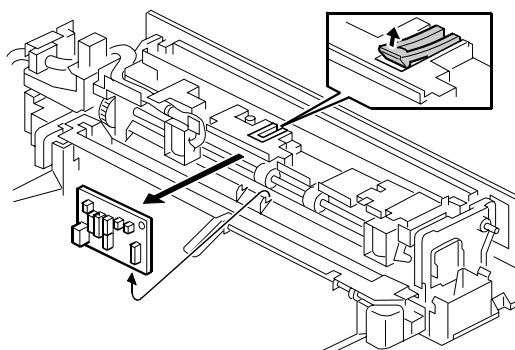

G305R102.WMF

Peripherals

2. DETAILED DESCRIPTIONS

2.1 ELECTRICAL COMPONENTS

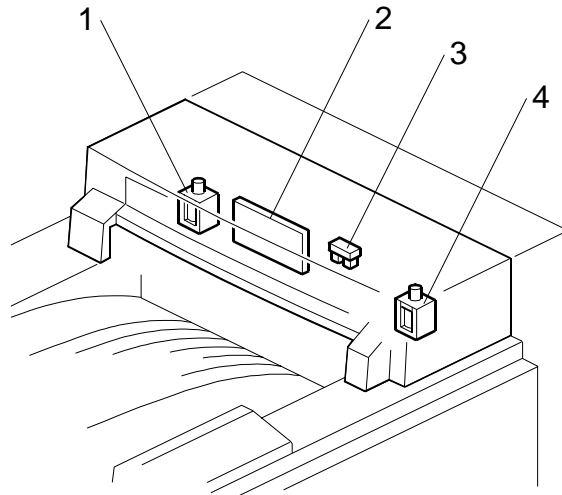

G305D102.WMF

- | | |
|------------------------|------------------------|
| 1. Upper gate solenoid | 3. Paper exit sensor |
| 2. Control board | 4. Lower gate solenoid |

2.2 DRIVE

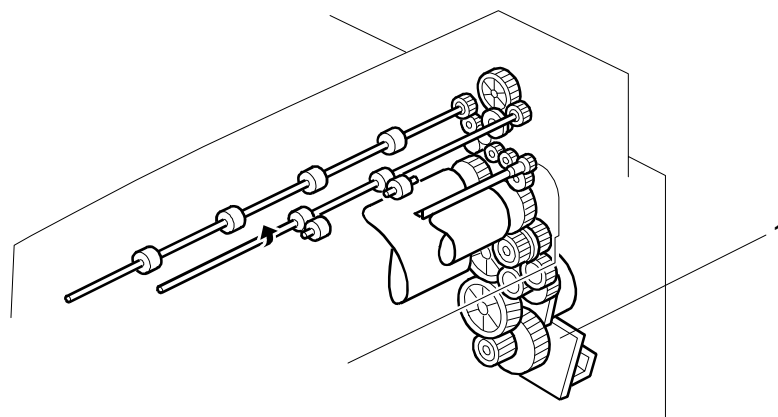

G305D103.WMF

1. Fusing unit motor (main body)

2.3 MECHANISM

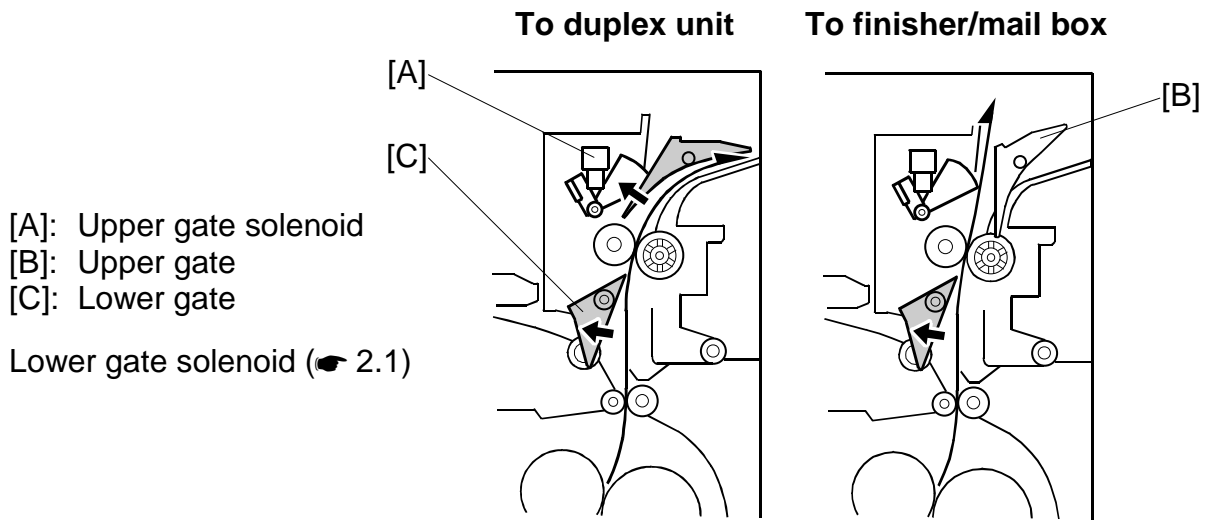

G305D104.WMF

The arrows in the right-hand column indicate paper path directions through the junction gates.

To ...	Solenoid		Gate	
	Upper	Lower	Upper	Lower
Main unit	Off	Off	↑*	←
	On	On	→	↑
Duplex unit	Off	On	↑	↑
	On	On	↑	↑

* Paper does not go through the upper gate.